



SG27-FHD240C

27" FHD 240Hz CURVED GAMING MONITOR

USER MANUAL



240Hz

RAPID REFRESH RATE

1ms

FAST RESPONSE TIME

CURVED

CURVED 27" MONITOR

FULL HD

FULL HD RESOLUTION

- Keep the monitor away from water sources or damp places, such as bath rooms, kitchens, basements and swimming pools.
- Make sure the monitor is placed on a flat surface. If the monitor falls down, it may cause human injury or device damage.
- Store and use the monitor in a cool, dry and well ventilated place, and keep it away from emission and heat sources.
- Do not cover or block the vent hole in the rear casing, and do not use the product on a bed, sofa, blanket or similar objects.
- The range of the supply voltage of the monitor is printed on the label on the rear casing. If it is impossible to determine the supply voltage, please consult the distributor or local power company.
- If the monitor will not be used for a long period, please cut off the power supply to avoid electric shock in rainy days and damage due to abnormal supply voltage.
- Please use a reliable earthing socket, do not overload the socket, or it may cause fire or electric shock.
- Do not put foreign matters into the monitor, or it may cause short circuits resulting fire or electric shock.
- Do not disassemble or repair this product by self to avoid electric shock. If faults occur, please contact the after-sales service directly.
- Do not pull or twist the power cable forcedly.
- There is a polarizer layer (not a protective film) on the surface of the screen. Do not peel it off, or the product may be damaged and the warranty will be invalid.

Packing list

- Please check that the package of the monitor contains all parts. If any part is lost, please contact the distributor.
- The color and shape of parts may vary with models. Figures in this User Manual are for reference only.
- Wires supplied may vary with purchased products. Figures in this User Manual are for reference only.



Monitor

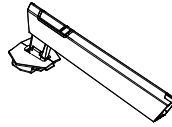

Stand stem

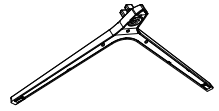

Base



Mount screw

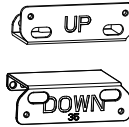

Mount adapter



Screwdriver

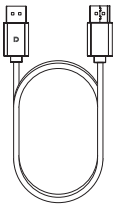

DP signal cable

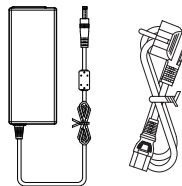

Power Adapter
& Power Cable



User Manual

Installation of base

1. Open the carton package, take out the foam and put it flat on the table top.

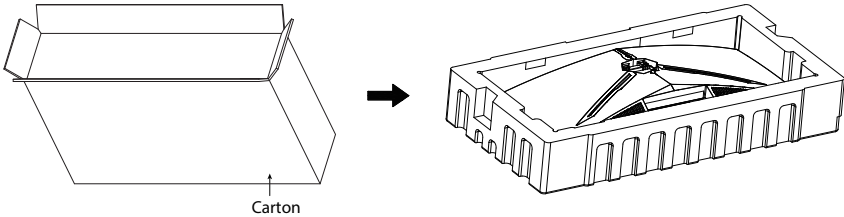

2. Take out the stand stem and base, and use the thumb screw of the base to lock the stand tightly. (See the figure below)

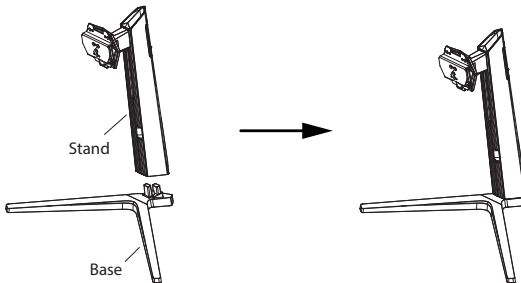

3. Put the assembled stand and base components into the slot of the rear casing, slightly press the stand to clip the rotary shaft component into position, hold the middle of the stand with hand to lightly lift the monitor twice to ensure that the monitor can not loose and the clip can lock the stand and base components firmly, and hold the assembled monitor with hands to stand it on the flat tabletop; during disassembly, perform these steps reversely.

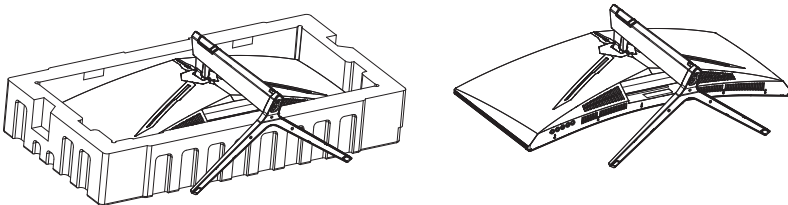

! Note: During standing of the whole monitor, do not press the liquid crystal screen with hand to avoid damage to the screen.

Installation of mount

1. Open the package, remove the foam from the monitor with the monitor back cover facing upwards. Remove the quick-release shaft assembly.

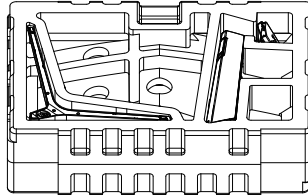

2. Take out the wall mount adapter and tighten the locking screw.

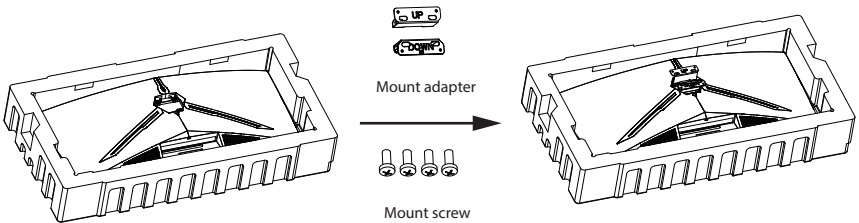

3. During padlocking of the monitor, do not pinch the screen with the hands to avoid damaging the screen. Install the mount to the mount stud by referring to the user manual of the mount (purchased separately).
Tips: The mounting hole distance of the mount for the product is 75x75mm.

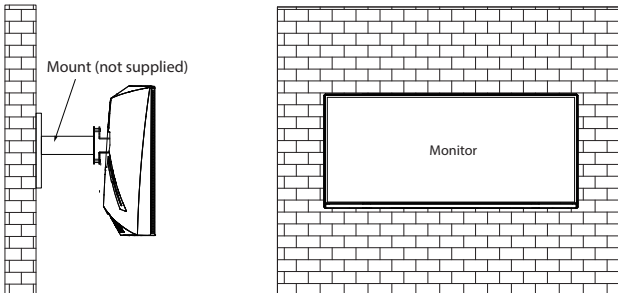

-  Notes: To prevent the monitor on the mount from failing, please install it firmly and protect it fully. Do not place or hang any object on the mount, and the using height of the mount should be less than 2 meters.

Adjusting the monitor

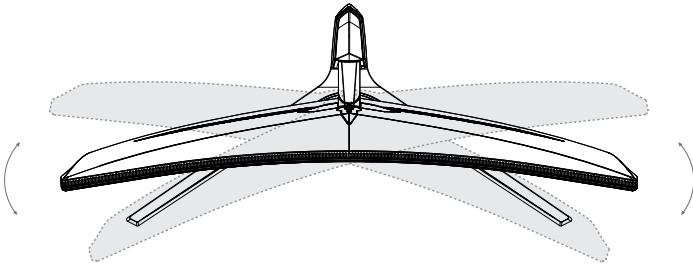

Rotation angle
 $-30^{\circ}(\pm 2.0^{\circ}) - +30^{\circ}(\pm 2.0^{\circ})$

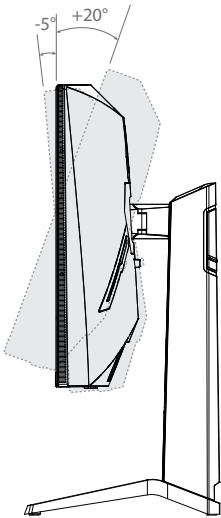

Tilting angle
 $-5^{\circ}(\pm 1.5^{\circ}) - +20^{\circ}(\pm 1.5^{\circ})$

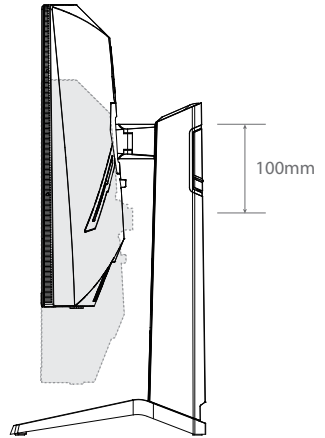

Height range
100mm (± 5.0 mm)

Description of buttons

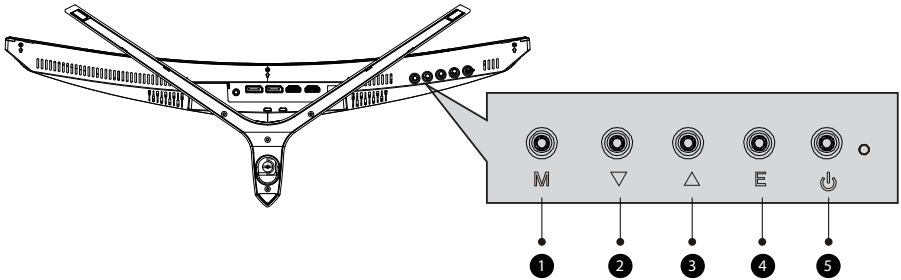

1	Menu button: Press to enter sub-menus/ quickly enter the main menu
2	Down button: Press to move down in the menu/quickly enter the game crosshair mode
3	Up button: Press to move up in the menu/quickly enter the contextual mode
4	Exit/hot key: Press to return to the previous menu/quickly switch the color format
5	Power button: Press to turn on/off the monitor

Explanation of indicators

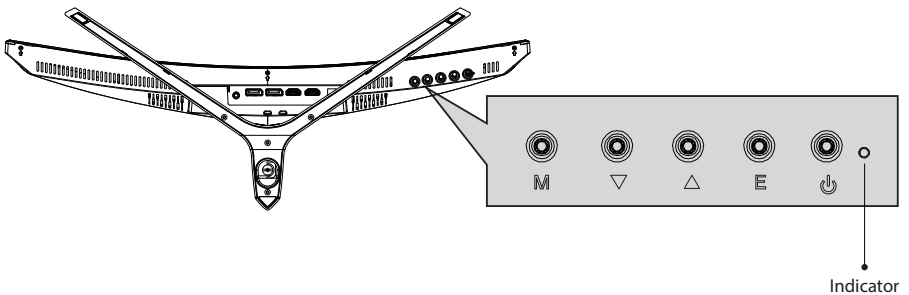

Indicator: Steady blue light indicates the power is on and the monitor runs normally. Flashing blue light indicate no video source and no horizontal or vertical signal detected or low voltage. Please make sure your computer is turned on and all video cables are fully plugged in and/or connected.

Cable connection:

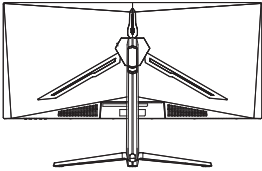

* The bottom interface configuration at the back of the monitor varies with products.

* Note: If the power cable or signal cable is damaged, you must replace it with special soft cables or special components purchased from the manufacture or maintenance department.

HDMI interface

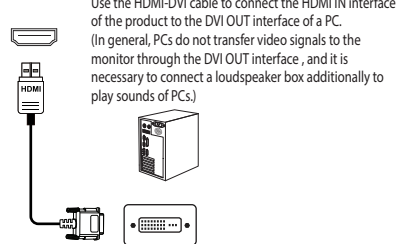
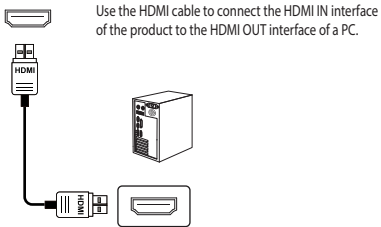

DP interface

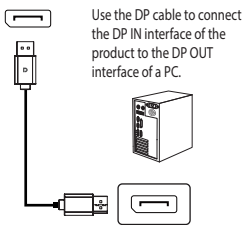

AUDIO OUT

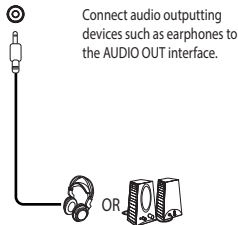

DC interface

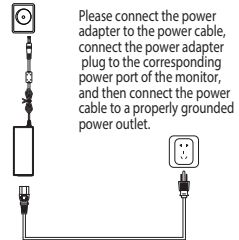

Menu description

- The color and shape of the OSD menu of the actual computer may be slightly different from them shown in the figure.
- Specifications of the OSD menu may change with improvements of functions without prior notice.

The screen display (OSD) menu can be used to adjust settings of the monitor and is shown on the screen after the monitor is powered on and the M button is pressed.

1. Press the button M to activate the browser screen.

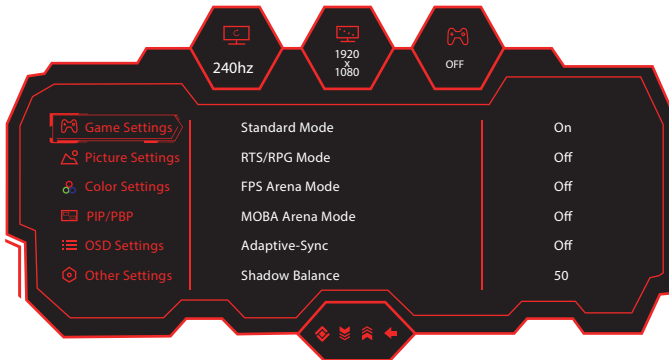

2. Press ▼ or ▲ to scroll through the functions.

- Select the desired function, and press M to enter the sub-menu.
- Press ▼ or ▲ to scroll through sub-menus, and press M key to select and confirm the desired function.
- Press ▼ or ▲ to select one option, and press M to confirm settings and exit from the current menu.

3. Press E to exit from the menu screen.

- Functions of the monitor vary with models, and the functions in this manual is for reference only.

Main Menu	Sub Menu	Option
Game Settings	Standard Mode	Off/On
	RTS/RPG Mode	Off/On
	FPS Arena Mode	Off/On
	MOBA Arena Mode	Off/On
	Adaptive-Sync	Off/On
	Shadow Balance	0-100
	Response Time	Off/Normal/Fast/Ultrafast
	Refresh Rate	Off/On/Window position
	Game Crosshair	Off/Game crosshair 1/Game crosshair 2/Game crosshair 3/ Game crosshair 4/Game crosshair 5/Game crosshair 6/ Crosshair position
	Game Time	Off/15: 00/30: 00/45: 00/60: 00/Window location
	Dynamic Brightness	Off/Normal/Expert/Elaboration
	MPRT	Off/On
	Ambient Lighting	Off/On
Picture Settings	Brightness	0-100
	Contrast	0-100
	DCR	Off/On
	Contextual Model	Off/Movie Mode/Reading Mode/Night mode
	Low Blue Light	0-100
	Sharpness	0-5
	Gamma	1.8/2.0/2.2/2.4/2.6/S.curve
	Aspect Ratio	Wide Screen/4:3/1:1/Auto
Color Settings	Warm	Off/On
	Natural	Off/On
	Cool	Off/On
	User1	Off/On
	User2	Off/On
	User3	Off/On
	Hue	0-100
	Saturation	0-100

Main Menu	Sub Menu	Option
PIP/PBP	PIP/PBP Mode	Off/PIP Mode/PBP 2Win 1:1
	Sub Win2 Input	DP1/DP2/HDMI1/HDMI2
	Audio Source	Auto/DP1/DP2/HDMI1/HDMI2
	PIP Position	Top Right/Top Left/Bottom Right/Bottom Left
	PIP Size	Small/Medium/Large
	Window Swap	Off/On
OSD Settings	Language	简体中文/English/한국어/عربي / Portugues do Brasilazil / Deutsch/Nederland/ Suomi/Français/Ελληνικά/Indonesia/Italiano/日本語/Malaysia/Polskie/ Português/Русский/Español/☒☒☒/Українська/Ti ng Vi t/繁体中文/Türkçe
	OSD Time Out	5-100
	OSD H-Position	0-100
	OSD V-Position	0-100
	OSD Transparency	0-5
	Hotkey1 Setting	Brightness/Contrast/Volume/Mute/Shadow Balance/Game Crosshair/ Refresh Rate/Game Time/Contextual Model/ PIP/PBP Mode /Input Signal /Dynamic Brightness
	Hotkey2 Setting	
	Hotkey3 Setting	
	OSD Rotation	Normal/90/180/270
OSD Lock	Off/On	
Other Settings	Input Signal	Auto/DP1/DP2/HDMI1/HDMI2
	Volume	0-100
	Mute	Off/On
	Auto Power	Off/On
	Eyeshield Remind	Off/On
	Reset	Off/On
	Information	Input Source: /Resolution: /Mode:

Basic parameters

Product Name	Liquid Crystal Display	
Product model	27GSH	
Screen Size	27 inches	
Aspect Ratio	16:9	
Viewing Angle	178°(H) / 178°(V)	
Pixel pitch	0.1038(H) × 0.3114 (V) mm	
Contrast ratio	3000:1 (TYP)	
Colors	16.7M	
Resolution	1920 x 1080	
Maximum refresh rate	240Hz	
Power Input	12V $\overline{=}$ 4.0A	
Product Dimensions	Without base	616.2 x 367.2 x 100 mm
	Lifting base	616.2 x 523.2 x 237.4 mm
Tilting angle	Forward tilting : 5° (\pm 1.5°); Backward tilting: 20° (\pm 1.5°)	
Height range	100 \pm 5mm	
Rotation angle	-30° / +30°(\pm 2°)	
Environmental conditions	Action	Temperature: 0°C~ 40°C (32°F ~ 104°F) Humidity: 10%~90% RH (non-condensing)
	Storage	Temperature: -20°~ 60° (-4°F ~ 140°F) Humidity: 5%~95% RH (non-condensing)



HIGH-DEFINITION MULTIMEDIA INTERFACE

HDMI, HDMI High Definition Multi-media Interface and the HDMI logo are trademarks or registered trademarks of HDMI Licensing Administrator, Inc. in the United States and other countries.

物料号码	108.007.xxxxx		
厂内型号	27GSH	厂外型号	待定
物料名称	说明书	品 牌	Sharkgaming
协力厂商		日 期	2022-02-22
规 格	140x210mm		
要 求	120G铜版纸 单色 骑马钉		
版 本	V01	设 计	韦慧芳
确 认		核 准	

备注:如不够页数,可以在封面封底的内面插入空白页.

